



Gospatrick Road, London, N17 7JD

£750,000

 5
  4
  2
  D

Cole Harding present this large five bedroom End of Terrace house located in Tottenham

The property is a HMO for 6 bedrooms and is ideal for a investor looking to achieve £5000 pcm coming in AT 10% rental yields.

Property offers 3 large rooms with en-suite (self contained), and one bathroom upstairs, living room and fitted kitchen diner.

The property has potential to also do parking for 3 cars, and has easy access to Wood Green tube station.

- Five bedroom End of Terrace
- HMO for 6 Bedrooms
- Rentals £6000 pcm
- Rental yields of 10%
- Potential for off street parking
- Close to Wood Green Tube station
- Freehold
- Chain free

Viewing

To arrange a viewing on this property or require further information please contact one of our team on 0208 059 4444

Approximate Gross Internal Floor Area = 126.4 sq m / 1362 sq ft

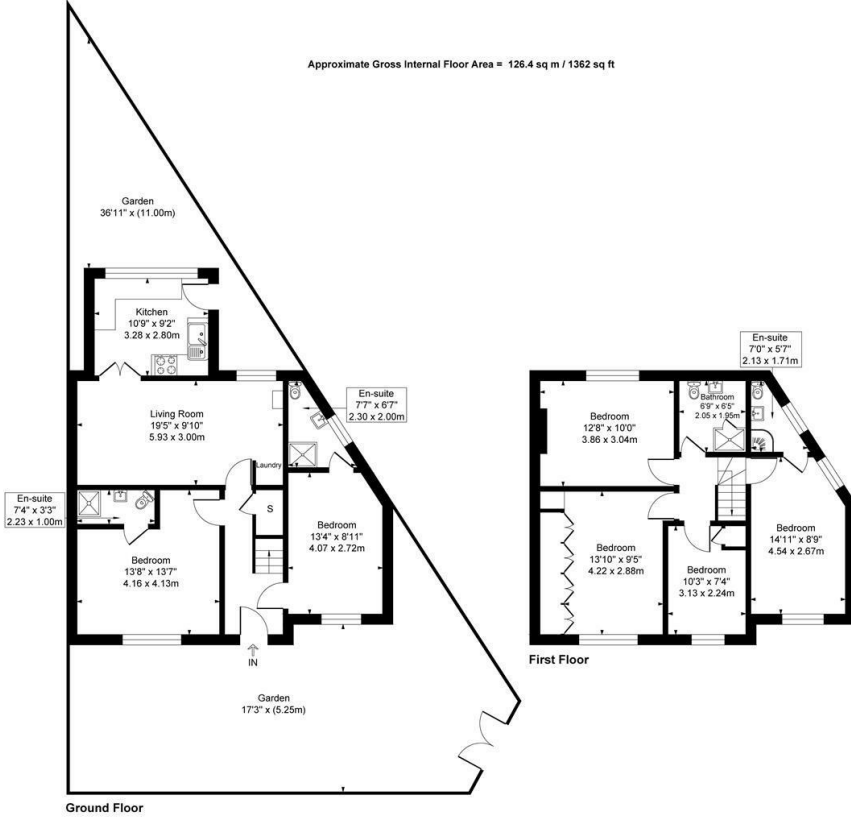
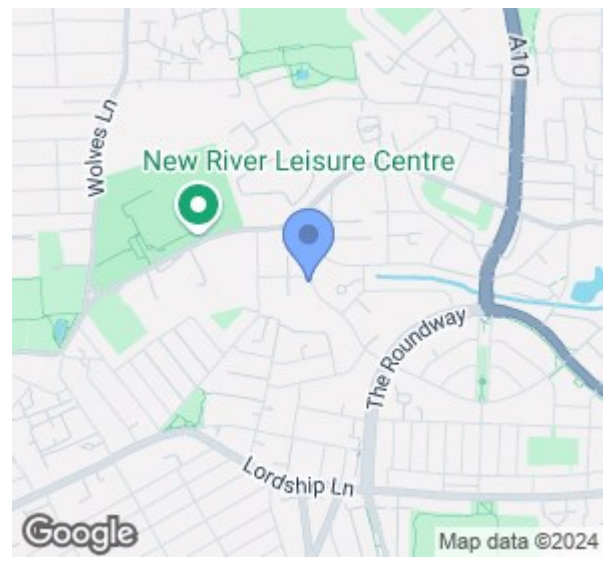

Illustration for identification purposes only, not in scale



Energy Efficiency Rating		Current	Potential
Very energy efficient - lower running costs			
(92 plus)	A		
(81-91)	B		79
(69-80)	C	67	
(55-68)	D		
(39-54)	E		
(21-38)	F		
(1-20)	G		
Not energy efficient - higher running costs			
England & Wales		EU Directive 2002/91/EC	



These particulars, whilst believed to be accurate are set out as a general outline only for guidance and do not constitute any part of an offer or contract. Intending purchasers should not rely on them as statements of representation of fact, but must satisfy themselves by inspection or otherwise as to their accuracy. No person in this firm's employment has the authority to make or give any representation or warranty in respect of the property.

Cole Harding

11 Northumberland Park, London, N17 0TA

T. 0208 059 4444 | E. info@coleharding.co.uk