



Northumberland Park, London, N17 0TB

Asking Price £750,000



Cole Harding Presents this four bedroom Semi-detach house located in Tottenham.



Viewing

To arrange a viewing on this property or require further information please contact one of our team on 0208 059 4444

Approximate Gross Internal Floor Area = 116.5 sq m / 1255 sq ft

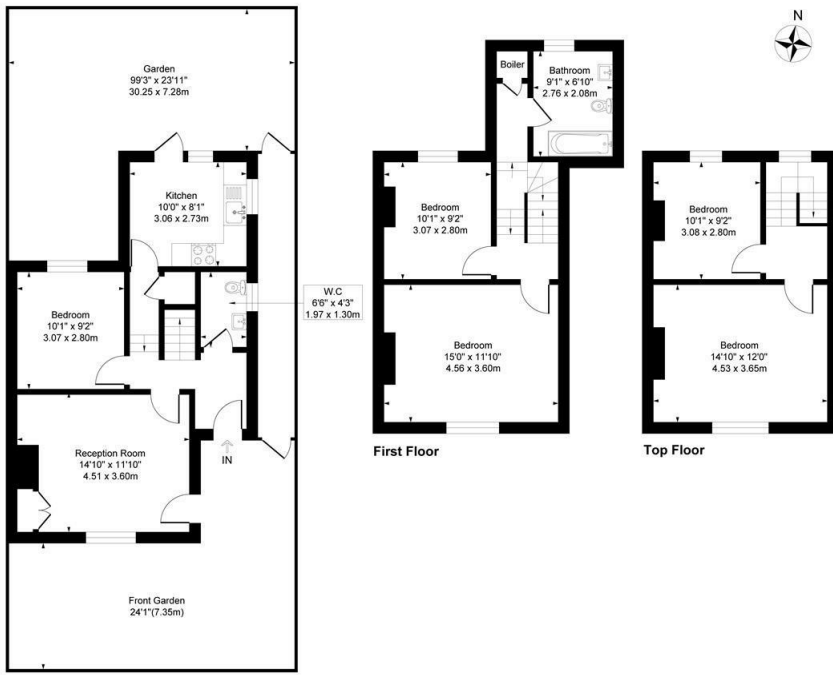

Energy Efficiency Rating		Current	Potential
Very energy efficient - lower running costs			
(92 plus)	A		
(81-91)	B		
(69-80)	C		
(55-68)	D		
(39-54)	E		
(21-38)	F		
(1-20)	G		
Not energy efficient - higher running costs			
England & Wales		EU Directive 2002/91/EC	

Illustration for identification purposes only, not in scale



These particulars, whilst believed to be accurate are set out as a general outline only for guidance and do not constitute any part of an offer or contract. Intending purchasers should not rely on them as statements of representation of fact, but must satisfy themselves by inspection or otherwise as to their accuracy. No person in this firm's employment has the authority to make or give any representation or warranty in respect of the property.

Cole Harding

11 Northumberland Park, London, N17 0TA

T. 0208 059 4444 | E. info@coleharding.co.uk